

E/PE

GIUNTI ELASTICI A PIOLI **CON PERNI SPECIALI** / PINS ELASTIC COUPLINGS **WITH SPECIAL PIVOT**

Giunto standard: ghisa UNI EN 1561 EN-GJL-HB 175

Standard coupling: cast iron UNI EN 1561 EN-GJL-HB 175

Perni standard: acciaio zincato

Standard pivot: galvanized steel

Piolo in gomma: Shore 75-80 temperatura di esercizio -20° +80°

Rubber pin: Shore 75-80 operating temperature -20° +80°

A richiesta giunto completamente in C45 o INOX

Coupling completely made of C45 or stainless steel upon request



TIPO TYPE	Mt torque [Nm]	[giri/min] [RPM] max	∅ grezzo/max. raw/max. [mm]	F [mm]	L [mm]	H [mm]	K [mm]	M [mm]	S [mm]	N° Perni Pivot	∅ Perni Pivot	peso weight [Kg]
E85PE	95	6100	- / 24	85	113	3	20	39	55	4	8XM8	2,5
E100PE	220	6050	- / 32	100	123	3	20	55	60	8	8XM8	4,5
E120PE	350	6000	- / 45	120	143	3	20	71	70	10	8XM8	6
E140PE	600	5300	- / 55	140	163	3	20	85	80	14	8XM8	9
E160PE	900	4500	- / 60	160	183	3	20	102	90	16	8XM8	14
E180PE	1300	4000	- / 65	180	204	4	25	103	100	12	12XM12	17
E200PE	1800	3600	- / 75	200	234	4	25	116	115	14	12XM12	24
E225PE	2600	3200	40 / 90	225	264	4	25	145	130	16	12XM12	36
E250PE	4600	3000	45 / 95	250	305	5	38	147	150	14	18XM18	49
E300PE	6500	2500	50 / 110	300	365	5	38	182	180	16	18XM18	84
E350PE	10500	2200	60 / 120	350	406	6	60	200	200	12	25XM24	130
E400PE	14500	1800	70 / 140	400	446	6	60	232	220	14	25XM24	190
E450PE	21000	1600	75 / 160	445	487	7	72	253	240	12	32XM30	260
E500PE	28000	1400	75 / 180	495	527	7	72	288	260	14	32XM30	350
E550PE	36000	1200	75 / 210	545	567	7	72	322	280	16	32XM30	450
E630PE	75000	1000	90 / 250	625	567	7	90	375	280	14	45XM24	710
E680PE	95000	900	90 / 270	680	567	7	90	405	280	16	45XM24	980
E800PE	146000	760	130 / 280	795	607	7	90	420	300	20	45XM24	1100
E900PE	200000	680	130 / 300	895	607	7	90	448	300	22	45XM24	1250
E1100PE	350000	600	130 / 350	1100	807	7	90	550	400	28	45XM24	2520

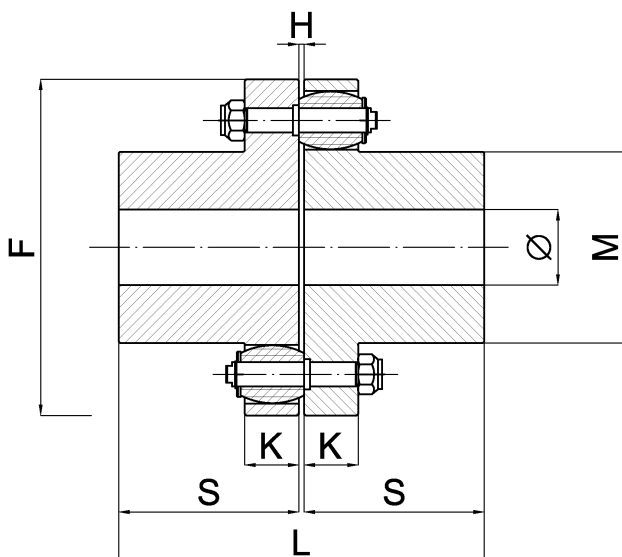

E630PE fino E1100PE
E630PE to E1100PE

